

## CYCLAIR-75 EXTRACTOR UNIT ASSEMBLY INSTRUCTIONS AND PARTS LIST

### ASSEMBLING EXTRACTOR UNIT.

CAUTION : Fan motor must not be switched on unless the machine is fully assembled according to the instructions below.

1.

Remove contents from carton (machine base packed under false bottom of carton). Check and identify parts from Parts List (see page 5), before attempting to assemble machine.

2.

Place skirt assembly on floor upside down (i.e. with retaining band upper most - see Fig.1). Assemble 3 legs to channels on skirt (see Fig.1) using 6 screws, 6 nuts, 12 washers and spanner supplied (do not fully tighten screws).

3.

Assemble 3 lower legs to upper legs as shown in Fig.2 using 6 screws, 6 nuts and 12 washers.

4.

Assemble base to legs (see Fig.3) using 6 screws, 6 nuts and 12 washers (do not fully tighten screws). Push 4 castors firmly into sockets in underside of base, or alternatively, the machine can be fitted with 4 bolting down brackets which can be secured to the base (see Fig.3). Turn machine right way up onto a level floor and check machine stands firmly without wobble and tighten all screws.

5.

Connect suction hose to inlet pipe on skirt using clip supplied (see Fig.4).

6.

Clip linen filter bag, brushed (fluffy) side inwards to top of skirt allowing approximately 40mm (1½") overlap. Fit a plastic collection bag to lower end of skirt and retain bag in position by tucking it under retaining band and fastening clip. Allow sufficient overlap to prevent the bag pulling off in use.

Connect the free end of the flexible suction hose to an appropriate 160mm (6½") or 110mm (4½") diameter extraction spigot.

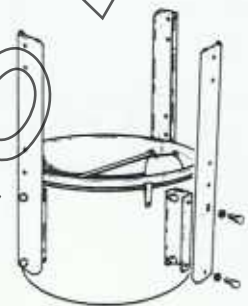

Fig.1.



Fig.2.

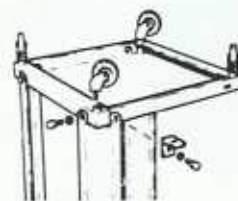

Fig.3.

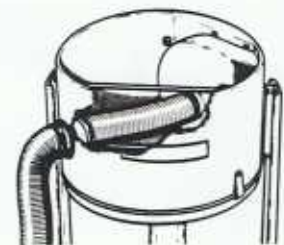

Fig.4.

**A.L.T. Saws & Spares Ltd**

Startrite Machine Specialist

Unit 15, Pier Road Industrial Estate

Gillingham

Kent

ME7 1RZ

Tel/Fax: 01634 850833

[www.altsawsandspares.co.uk](http://www.altsawsandspares.co.uk)

ALL DIMENSIONS APPROXIMATE

ALL DIMENSIONS APPROXIMATE

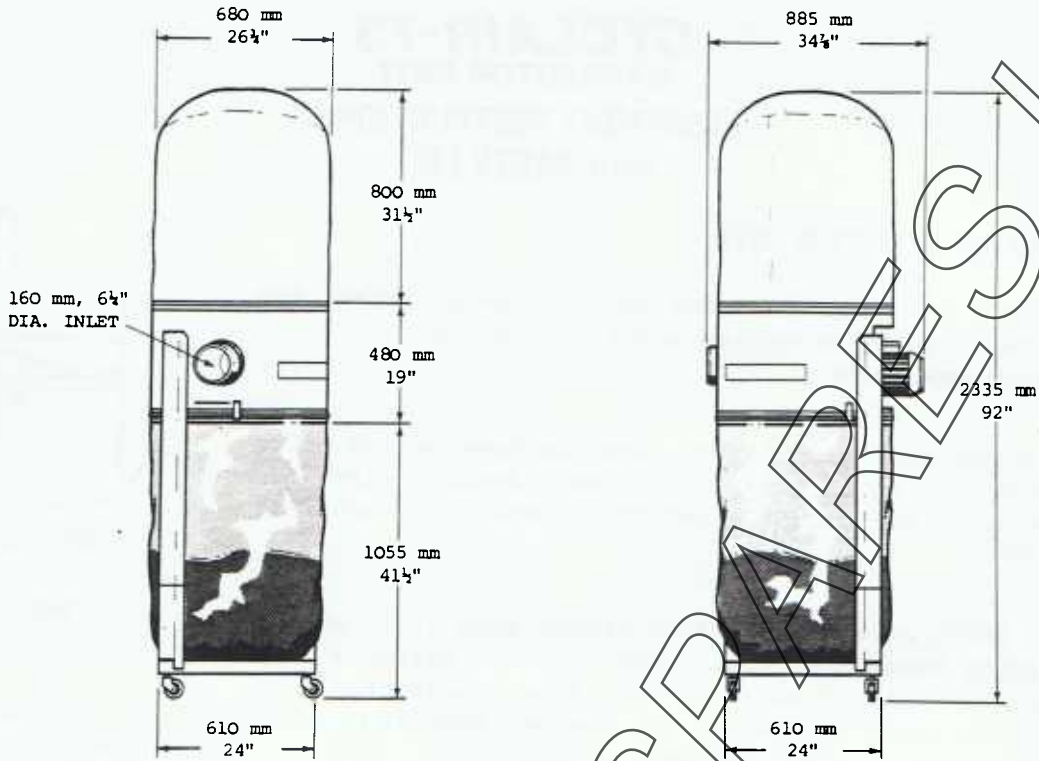

FOUNDATION PLAN FOR CYCLAIR 75 EXTRACTOR UNIT.

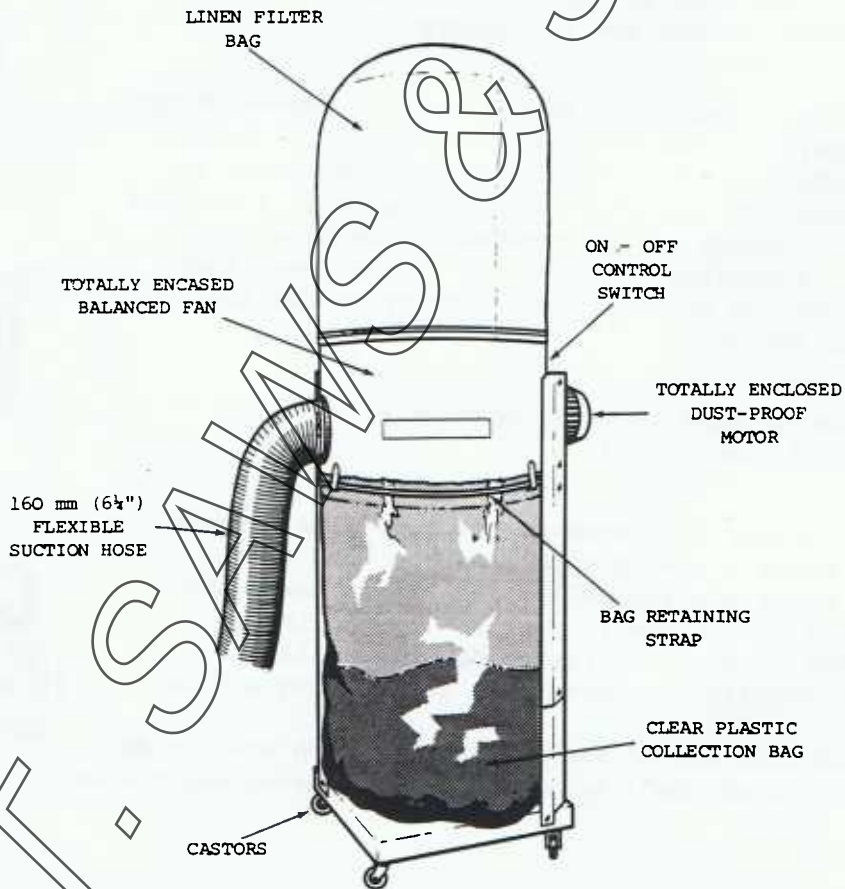

GENERAL LAYOUT OF CYCLAIR 75 EXTRACTOR UNIT.

Motor Output	-	1 & 3 Phase : 0.75 kW., 1 h.p.
Motor/Fan Speed	-	1 & 3 Phase : 2850 r.p.m.
Suction Rate at Inlet	-	29.5 m <sup>3</sup> /min., 1045 ft <sup>3</sup> /min. *
Suction Inlet Diameter	-	160 mm, 6 $\frac{1}{4}$ "
Nominal Collection Capacity	-	0.25 m <sup>3</sup> , 9 ft <sup>3</sup> *
Standard Voltages	-	415 Volt 3 Phase 50Hz.
	-	240 Volt 1 Phase 50Hz.
Weight	-	59 kg., 130 lbs.

\* Will vary according to material collected and state of filter.

### CONNECTION TO THE ELECTRICITY SUPPLY.

**IMPORTANT :** Check that the supply voltage is suitable for operation of the machine. (Voltage marked on motor plate and label on carton). Ensure that the machine is isolated from mains supply before making any electrical connections or adjustments.

To connect machine to mains supply, proceed as follows :- Remove cover of starter (two screws).

**FOR SINGLE PHASE SUPPLY,** connect two supply leads to top terminals L1 & L3 of contactor an earth lead (yellow/green) must be connected to earth terminal of starter (See Fig.1).

Connect brown lead to a 13 amp fused supply, blue lead to neutral and yellow/green lead to earth. Temporary connection can be made to a 13 amp ring main circuit by fitting a standard plug.

**FOR THREE PHASE SUPPLY,** connect three supply leads to top terminals L1, L2 & L3 of contactor an earth lead (yellow/green) must be connected to earth terminal of starter (See Fig.2).

Connect three brown leads to a fused supply and the yellow/green lead to earth. If the motor runs when switched on but there is no suction, the motor is running in the wrong direction. To reverse rotation, interchange any two brown leads.

**IMPORTANT: IN ALL CASES THE MACHINE MUST BE EFFECTIVELY EARTHED.**

It is recommended that the machine is connected to the mains supply by an electrical engineer.

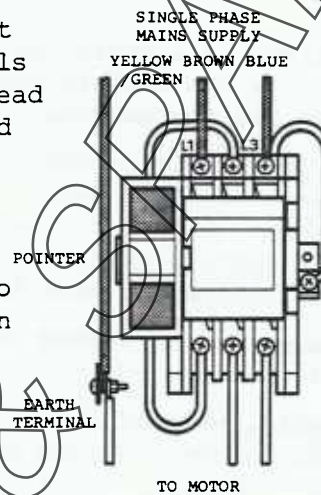

Fig.1.

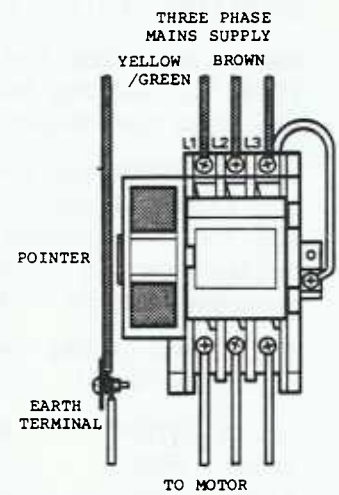

Fig.2.

## CONNECTION TO THE ELECTRICITY SUPPLY (CONTINUED).

Fuse and cable recommendations given (see chart) are intended as a general guide only, as local regulations and/or operating conditions may require alternative specifications to be adopted. Motor full load current may vary according to construction. The actual full load current is marked on the motor. Connect the machine to a fused isolator of suitable capacity (see chart) using cable incased in conduit. Temporary connection (ie. for demonstrations) may be made with flexible cables, provided that it is protected from accidental damage.

MAINS SUPPLY	FULL LOAD AMPS	MIN WIRE SIZE mm <sup>2</sup>	MAX FUSE AMPS
220/240 VOLT 1 PHASE	4.7	1.0	15
220/240 VOLT 3 PHASE	3.12	1.0	15
380/440 VOLT 3 PHASE	1.8	1.0	10

## OPERATING INSTRUCTIONS.

Before emptying the plastic collection bag, switch off the motor, shake the linen filter bag and allow the dust to settle. Do not disturb the filter bag when the collection bag is removed.

Do not allow the plastic collection bag to fill up completely. More of the bag capacity can be used for light debris such as loose planer chips than say for heavy close packed sawdust. It saves wear and tear on the plastic collection bag if it is emptied while it can still be easily handled. A torn collection bag is useless and must be discarded.

The linen filter bag must not be washed and should be replaced annually or otherwise as dependent upon use.

Avoid large solid objects, wads of rag or paper etc. entering the suction inlet. Should a blockage occur - SWITCH OFF THE MOTOR IMMEDIATELY.

Always isolate machine from mains supply before gaining access to the fan to clear the obstruction. With machine isolated, access to the fan can be gained by removing plastic collection bag and unclipping the internal hose from the fan housing.

**CAUTION:** The motor must not be switched on unless the machine is fully operational - ie. with internal hose clipped in place and with both the linen filter and plastic collection bags in place.

**IMPORTANT:** This unit should not be used with Abrasive Linishers or Sanding Machines, or for the extraction of TOXIC fumes or dust (in such cases it is necessary to seek expert advice). This unit is intended for the collection of sawdust & chippings from woodworking machinery.

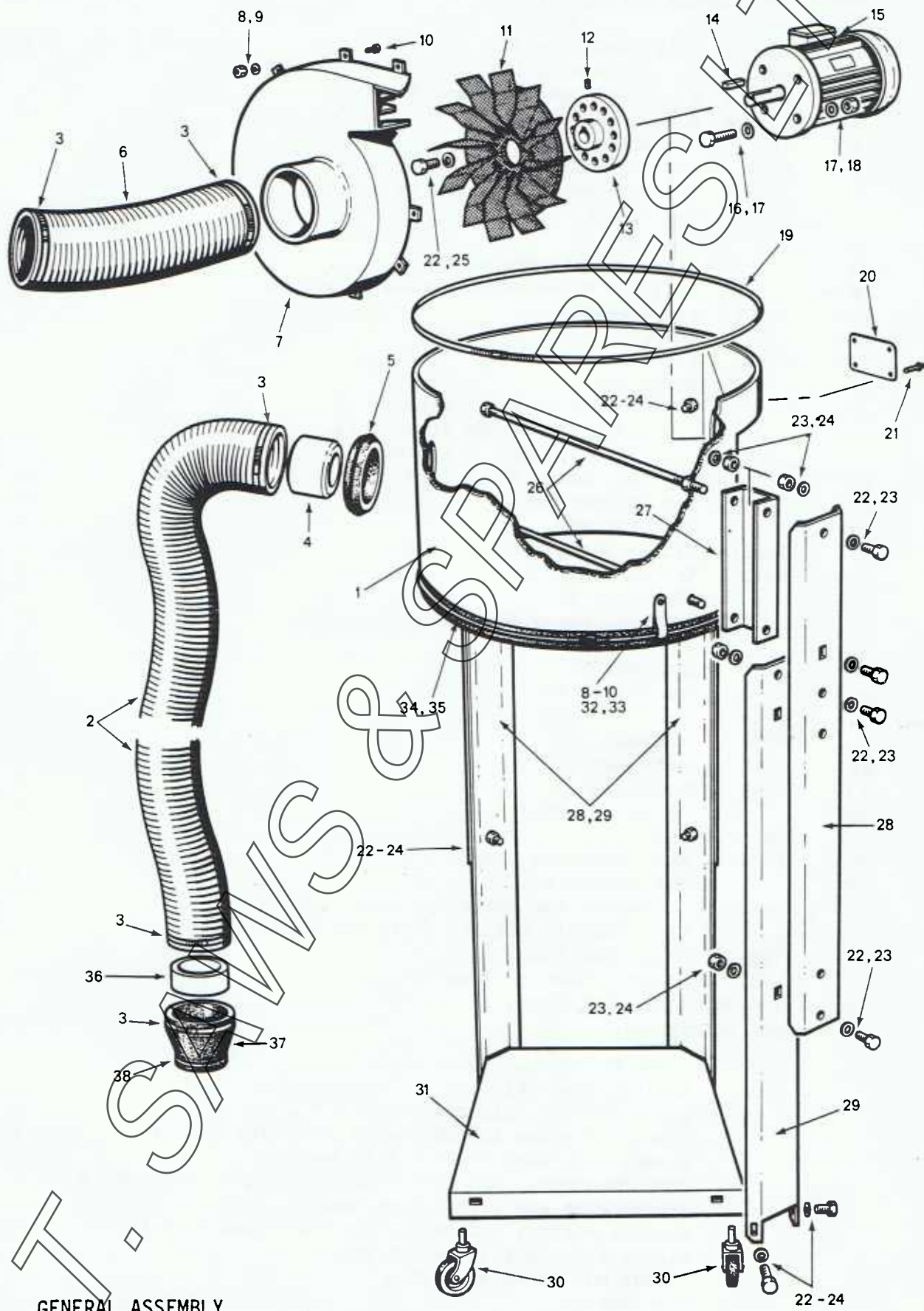

GENERAL ASSEMBLY

GENERAL ASSEMBLY - CYCLAIR 75 EXTRACTOR UNIT.

ITEM	PART NUMBER AND DESCRIPTION	No. OFF
1	SM1052 Skirt Assembly 3PH	1
	SM1051 Skirt Assembly 1PH	
2	5588/8 Flexible Hose	1
3	5588/6 Hose Clip	5
4	8175 Connection Pipe	1
5	5636 Sealing Rubber	1
6	5588/7 Flexible Hose	1
7	SM1058 Fan Housing	1
8	Hex. Nut	12
9	Shakeproof Washer	12
10	Phillips Recessed Hd. Screw	12
11	SM1057 Fan Assembly	1
12	Soc. Set Screw	1
13	5642 Fan Hub	1
14	Motor Key	1
15	Motor 220/3/50Hz Starcro 59.	1
	380/420/3/50Hz Starcro 59.	
	240/1/50Hz Starcro 60.	
16	Hex. Hd. Screw	4
17	Std. Washer	8
18	Hex. Nut	4
19	SM1028 Filter Bag Retaining Band.	1
20	5573/2 Instruction Plate	1
21	Pop Rivet	4
22	Hex. Hd. Screw	14
23	Std. Washer	12
24	Hex. Nut	10
25	Tab Washer	12
26	5549 Strut	2
27	5548 Channel	3
28	5540 Upper Leg	3
29	5539 Lower Leg	3
30	Castor No.	4
31	SM1022 Base	1
32	5574 Band Retaining Loop	3
33	Std. Washer	3
34	SM1652 Collection Bag Retaining Band	1
35	Self-Adhesive Sealing Strip	1
36	5922 Connection Pipe	1
37	5688 Reducer	1
38	5587/6 Hose Clip	1
	NOT ILLUSTRATED	
	5583 Linen Filter Bag	1
	5637 Bolting Down Brackets	4
	Clear Plastic Collection Bag	10
	Simplex Starter	1
	Heater Pack AHBG	
	Simplex Starter	1
	Heater Pack AHB	
	Simplex Starter	1
	Heater Pack	
	Cheese Hd. Screw	2
	Hex. Nut	2
	Shakeproof Washer	2

NOTE : It is recommended that the extractor unit be positioned as close as possible to the collection point, and should be installed with as few bends or elbows as possible.

For extracting from more than one machine a single branch is available which can be used to connect to 160 mm dia. spigot at collection point. Reducers can be used where the collection spigots are 110 mm dia.

Straight pipe sections supplied in 1.5 m lengths

Inlet pipe (standard equipment)

2.5 m flexible hose (standard equipment) for coupling directly to 160 mm dia. spigot

Double socket for joining straight pipes together, or fitting to elbow or single branch

Pipe fixing bracket

Single socket for quick release, or flexible hose may be clipped direct to straight pipe

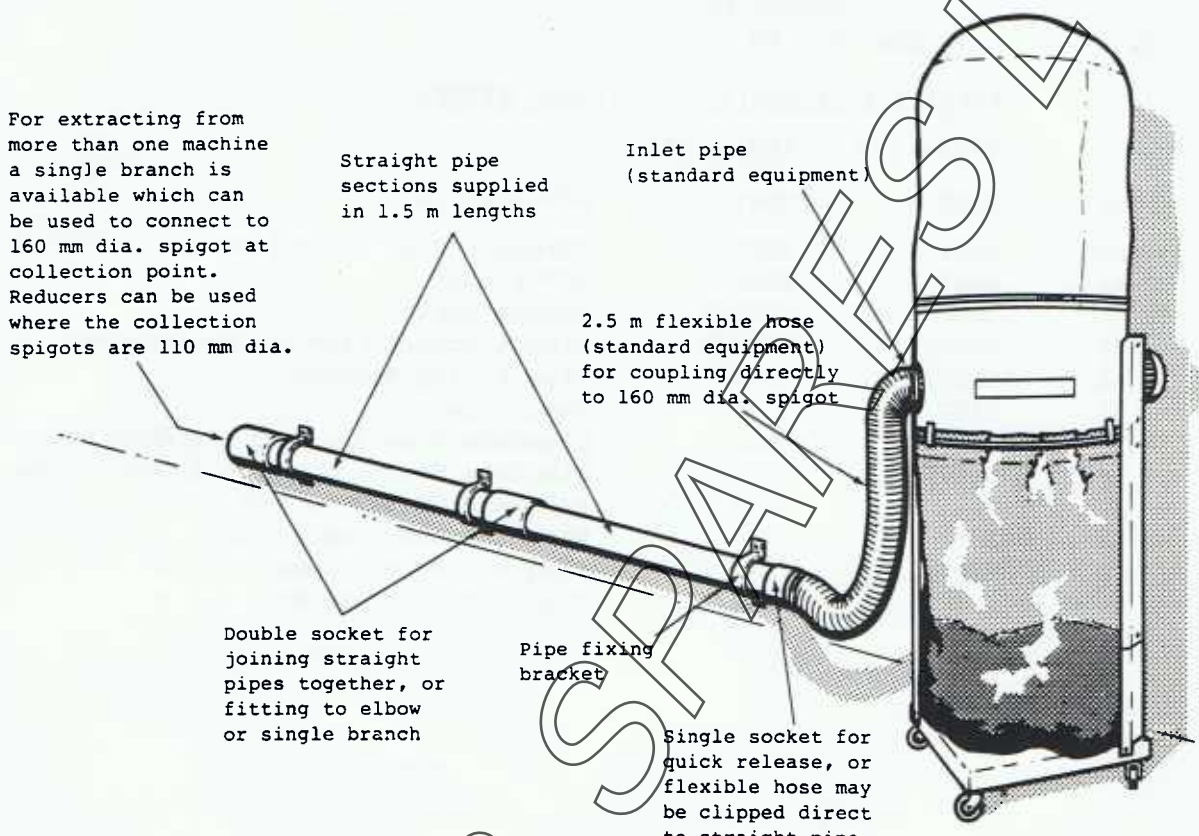

TYPICAL INSTALLATION SHOWING THE EXTRACTOR UNIT POSITIONED AWAY FROM THE COLLECTION POINT, USING OPTIONAL EXTRAS SHOWN BELOW.

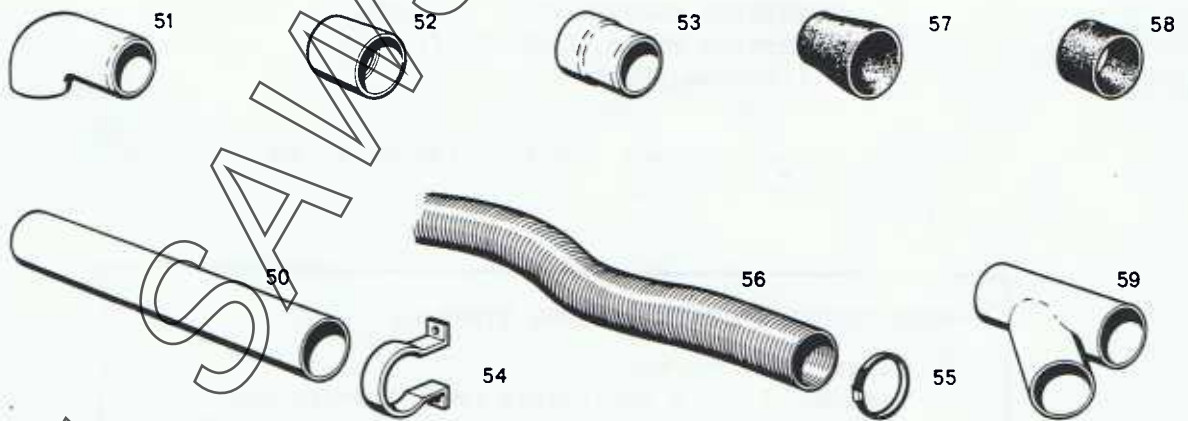

PIPES & ACCESSORIES - OPTIONAL EXTRAS

ASSEMBLY TOOL KIT (IN PLASTIC BAG) :

5056	Spanner	1
22	Hex. Hd. Screw	19
23	Std. Washer	38
24	Hex. Nut	19

PIPES & ACCESSORIES - OPTIONAL EXTRAS

110 mm DIA. 160 mm DIA.

ITEM	PART No.	PART No.	DESCRIPTION
50	5587/1	5588/1	Straight Pipe 1.5 m Long
51	5587/2	5588/2	90° Elbow
52	5587/3	5588/3	Double Socket
53	5587/4	5588/4	Single Socket (For quick release)
54	5587/5	5588/5	Pipe Fixing Bracket
55	5587/6	5588/6	Hose Clip
56	5587/9	5588/9	Flexible Hose 3 m Long + 2 Hose Clips
56	5587/10	5588/10	Flexible Hose 6 m Long + 2 Hose Clips
57	-	5688	Reducer 160 mm - 110 mm
58	5687	-	Rubber Connecting Sleeve
59	5587/11	-	Single Branch 110 mm x 110 mm
59	-	5588/11	Single Branch 160 mm x 110 mm

STARTRITE MACHINE TOOL Co. Ltd.,  
 Waterside Works, Gads Hill,  
 Gillingham, Kent,  
 ME7 2SF, England.

WHEN ORDERING PARTS, PLEASE STATE :-

1. Quantity required.
2. Part No. (where applicable) and description.  
Specify power supply for electrical components.
3. Machine Model and Serial No.

We reserve the right to change design and specification without notice.  
 Startrite Machine Tool Co. Ltd., Waterside Works, Gads Hill,  
 Gillingham, Kent, ME7 2SF, England.