

STARTRITE®

CYCLAIR-55 EXTRACTOR UNIT

ASSEMBLY INSTRUCTIONS AND PARTS LIST

ASSEMBLING EXTRACTOR UNIT.

CAUTION : Fan motor must not be switched on unless the machine is fully assembled according to the instructions below.

1.

Remove contents from carton (machine base packed under false bottom of carton). Check and identify parts from Parts List (see page 5), before attempting to assemble machine.

2.

Place skirt assembly on floor upside down (i.e. with retaining band upper most - see Fig.1). Assemble 3 legs to channels on skirt (see Fig.1) using 6 screws, 6 nuts, 12 washers and spanner supplied (do not fully tighten screws).

3.

Assemble base to legs (see Fig.2) using 6 screws, 6 nuts and 12 washers (do not fully tighten screws). Push 4 castors firmly into sockets in underside of base, or alternatively, the machine can be fitted with 4 bolting down brackets which can be secured to the base (see Fig.2). Turn machine right way up onto a level floor and check machine stands firmly without wobble and tighten all screws.

4.

Connect suction hose to inlet pipe on skirt using clip supplied (see Fig.4).

5.

Clip linen filter bag, brushed (fluffy) side inwards to top of skirt allowing approximately 40mm (1½") overlap. Fit a plastic collection bag to lower end of skirt and retain bag in position by tucking it under retaining band and fastening clip. Allow sufficient overlap to prevent the bag pulling off in use.

Connect the free end of the flexible suction hose to an appropriate 110mm (4½") diameter extraction pipot.

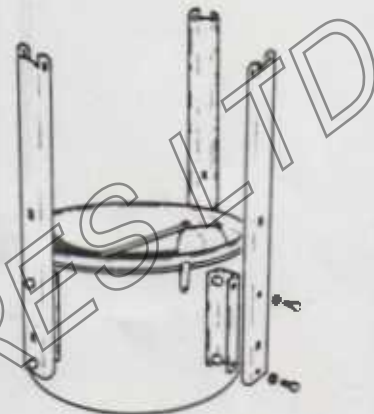

Fig.1.

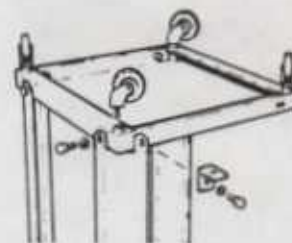

Fig.2.

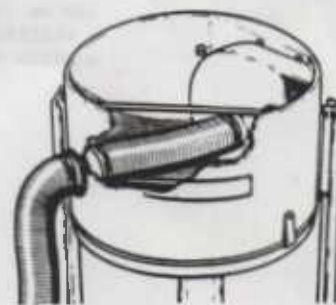
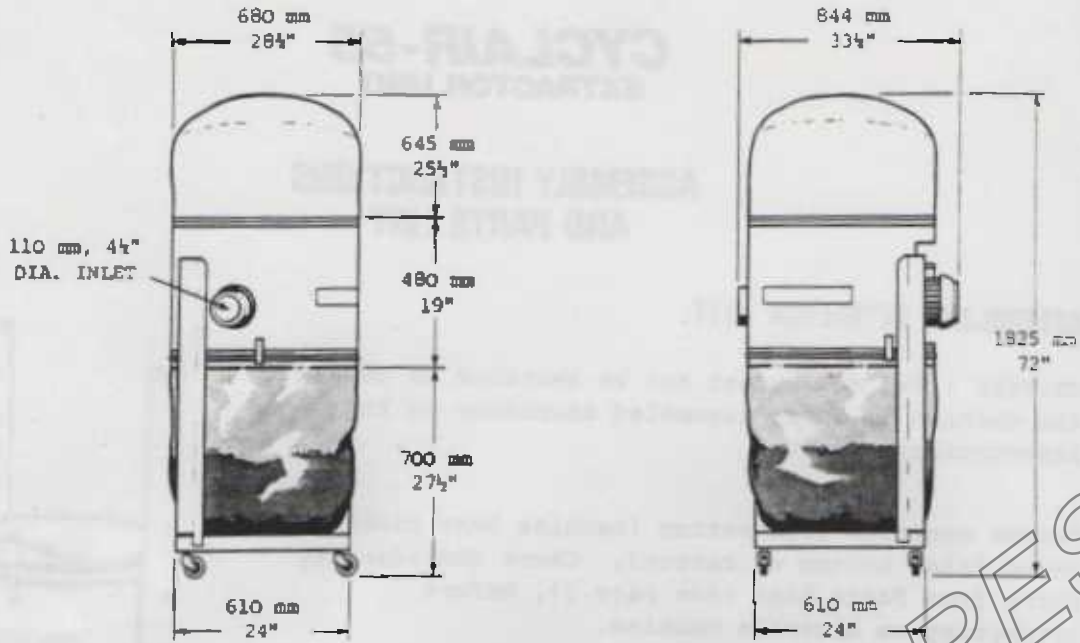
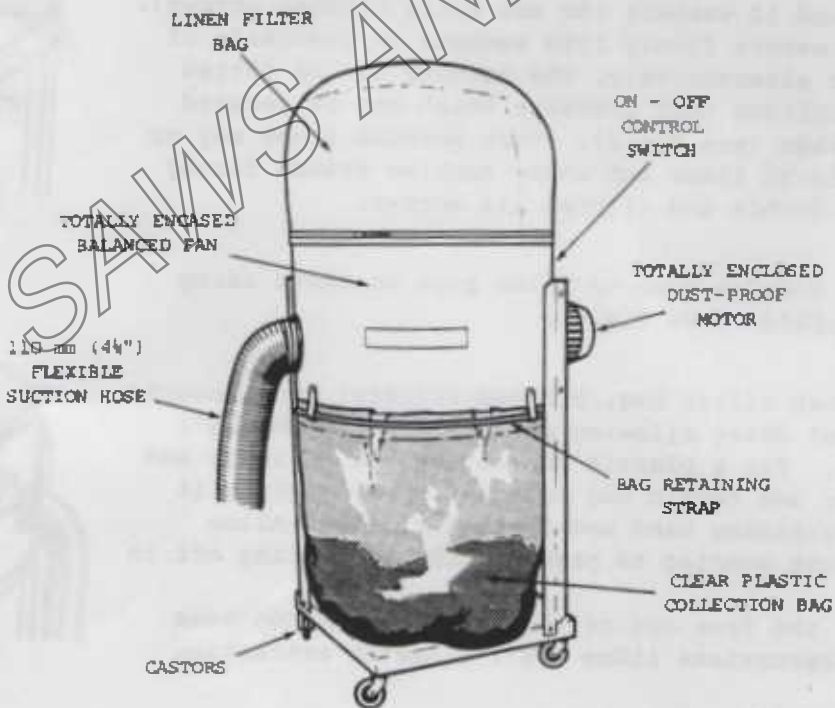

Fig.3.

ALL DIMENSIONS APPROXIMATE



OVERALL DIMENSIONS FOR CYCLAIR 55 EXTRACTOR UNIT.



GENERAL LAYOUT OF CYCLAIR 55 EXTRACTOR UNIT.

SPECIFICATIONS :

Motor Output	-	1 & 3 Phase : 0.55 kW., ¾ h.p.
Motor/Fan Speed	-	1 & 3 Phase : 2850 r.p.m.
Suction Rate at Inlet	-	16 m ³ /min., 565 ft ³ /min. *
Suction Inlet Diameter	-	110 mm, 4½"
Nominal Collection Capacity	-	0.14 m ³ , 5 ft ³ *
Standard Voltages	-	415 Volt 3 Phase 50Hz. 240 Volt 1 Phase 50Hz.
Weight	-	50 kg., 110 lbs.

* Will vary according to material collected and state of filter.

CONNECTION TO THE ELECTRICITY SUPPLY.

IMPORTANT : Check that the supply voltage is suitable for operation of the machine. (Voltage marked on motor plate and label on carton). Ensure that the machine is isolated from mains supply before making any electrical connections or adjustments.

To connect machine to mains supply, proceed as follows :- Remove cover of starter (two screws).

FOR SINGLE PHASE SUPPLY connect two supply leads to top terminals L1 & L3 of contactor an earth lead (yellow/green) must be connected to earth terminal of starter.

(See Fig. 1).

Connect brown lead to a 13 amp fused supply, blue lead to neutral and yellow/green lead to earth. Temporary connection can be made to a 13 amp ring main circuit by fitting a standard plug.

FOR THREE PHASE SUPPLY, connect three supply leads to top terminals L1, L2 & L3 of contactor an earth lead (yellow/green) must be connected to earth terminal of starter

(See Fig. 2).

Connect brown three leads to a fused supply and the yellow/green lead to earth. If the motor runs when switched on but there is no suction, the motor is running in the wrong direction. To reverse rotation, interchange any two brown leads.

IMPORTANT : IN ALL CASES THE MACHINE MUST BE EFFECTIVELY EARTHED.

It is recommended that the machine is connected to the mains supply by an electrical engineer.

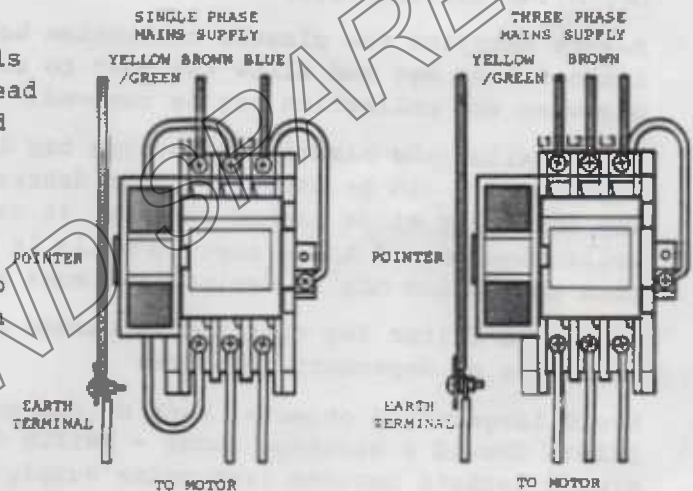

Fig. 1.

Fig. 2.

240V
KS0009 - WITH 4-6.3 o/c

415V
KS0010 - WITH 2.8-4 o/c.

CONNECTION TO THE ELECTRICITY SUPPLY (CONTINUED).

Fuse and cable recommendations given (see chart) are intended as a general guide only, as local regulations and/or operating conditions may require alternative specifications to be adopted. Motor full load current may vary according to construction. The actual full load current is marked on the motor. Connect the machine to a fused isolator of suitable capacity (see chart) using cable incased in conduit. Temporary connection (ie. for demonstrations) may be made with flexible cables, provided that it is protected from accidental damage.

MAINS SUPPLY	FULL LOAD AMPS	MIN WIRE SIZE mm ²	MAX FUSE AMPS
220/240 VOLT 1 PHASE	3.7	1.0	15
220/240 VOLT 3 PHASE	3.12	1.0	15
380/440 VOLT 3 PHASE	1.8	1.0	10

OPERATING INSTRUCTIONS.

Before emptying the plastic collection bag, switch off the motor shake the linen filter bag and allow the dust to settle. Do not disturb the filter bag when the collection bag is removed.

Do not allow the plastic collection bag to fill up completely. More of the bag capacity can be used for light debris such as loose planer chips than say for heavy close packed sawdust. It saves wear and tear on the plastic collection bag if it is emptied while it can still be easily handled. A torn collection bag is useless and must be discarded.

The linen filter bag must not be washed and should be replaced annually or otherwise as dependent upon use.

Avoid large solid objects, wads of rag or paper ect. entering the suction inlet. Should a blockage occur - SWITCH OFF THE MOTOR IMMEDIATELY.

Always isolate machine from mains supply before gaining access to the fan to clear the obstruction. With the machine isolated, access to the fan can be gained by removing plastic collection bag and unclipping the internal hose from the fan housing.

CAUTION : To avoid any possibility of personal injury or damage to the machine the motor must not be switched on unless the machine is fully operational - ie. with the internal hose clipped in place and with both the linen filter and plastic collection bags in place.

IMPORTANT : This unit should not be used where fine dust is generated such as with Abrasive Linishers or Sanding Machines, or for the extraction of TOXIC fumes or dust (in such cases it is necessary to seek expert advice). This unit is intended for the collection of sawdust and chippings from Woodworking Machinery and should not be used for other purposes.

GENERAL ASSEMBLY - CYCLIC IS CIRCULAR UNIT

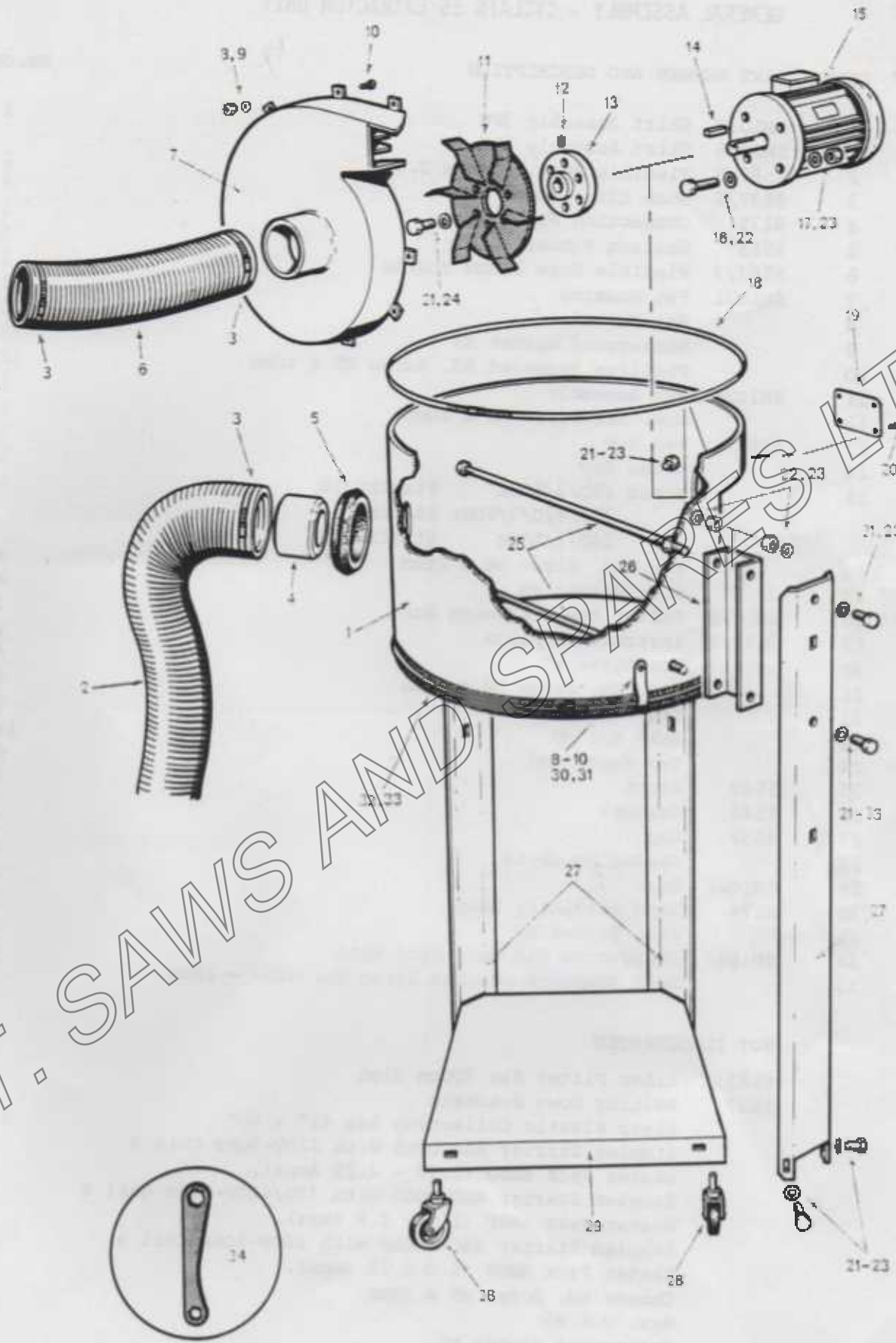

A.L.T. SAWS AND SPARKS LTD

GENERAL ASSEMBLY

GENERAL ASSEMBLY - CYCLAIR 55 EXTRACTOR UNIT

ITEM	PART NUMBER AND DESCRIPTION	No. OFF
1	SM1030 Skirt Assembly 3PH	1
	SM1016 Skirt Assembly 1PH	
2	5587/8 Flexible Hose 110mm x 2.5mm	1
3	5587/6 Hose Clip 110mm	5
4	8175 Connection Pipe	1
5	5555 Sealing Rubber	1
6	5587/7 Flexible Hose 110mm x 0.5m	1
7	SM1021 Fan Housing	1
8	Hex Nut M5	12
9	Shakeproof Washer M5	12
10	Phillips Recessed Hd. Screw M5 x 10mm	12
11	SM1020 Fan Assembly	1
12	Soc. Set Screw M8 x 10mm	1
13	5551 Fan Hub	1
14	Motor Key	1
15	Motor 220/3/50Hz Starcro 58	1
	380/420/3/50Hz Starcro 58	
	240/1/50Hz Starcro 57	
16	Hex. Hd. Screw M8 x 25mm	4
17	Std. Washer M8	8
18	SM1028 Filter Bag Retaining Band	1
19	5573/1 Instruction Plate	1
20	Pop Rivet 1/4"	4
21	Hex. Hd. Screw M8 x 12mm	8
22	Std. Washer M8	8
23	Hex. Nut M8	14
24	Tab Washer M8	6
25	5549 Strut	2
26	5548 Channel	3
27	5539 Leg	3
28	Castor No. OP-13	4
29	SM1022 Base	1
30	5574 Band Retaining Loop	3
31	Std. Washer M5	3
32	SM1652 Collection Bag Retaining Band	1
33	Self Adhesive Sealing Strip No. 4259 - 12mm	1

NOT ILLUSTRATED

5583	Linen Filter Bag 700mm High	1
5637	Bolting Down Brackets	4
	Clear Plastic Collection Bag 42" x 50"	10
	Simplex Starter AAD 0005 With 220V-50Hz Coil & Heater Pack AHBG (2.75 - 4.25 Amps).	1
	Simplex Starter AAD 0005 With 380/420V-50Hz Coil & Heater Pack AHBG (1.8 - 2.8 Amps).	1
	Simplex Starter AAD 0005B With 240V-50Hz Coil & Heater Pack AHBH (4.0-6.25 Amps).	1
	Cheese Hd. Screw M5 x 20mm	2
	Hex. Nut M5	2
	Shakeproof Washer M5	2

NOTE : It is recommended that the extractor unit be positioned as close as possible to the collection point, and should be installed with as few bands or elbows as possible.

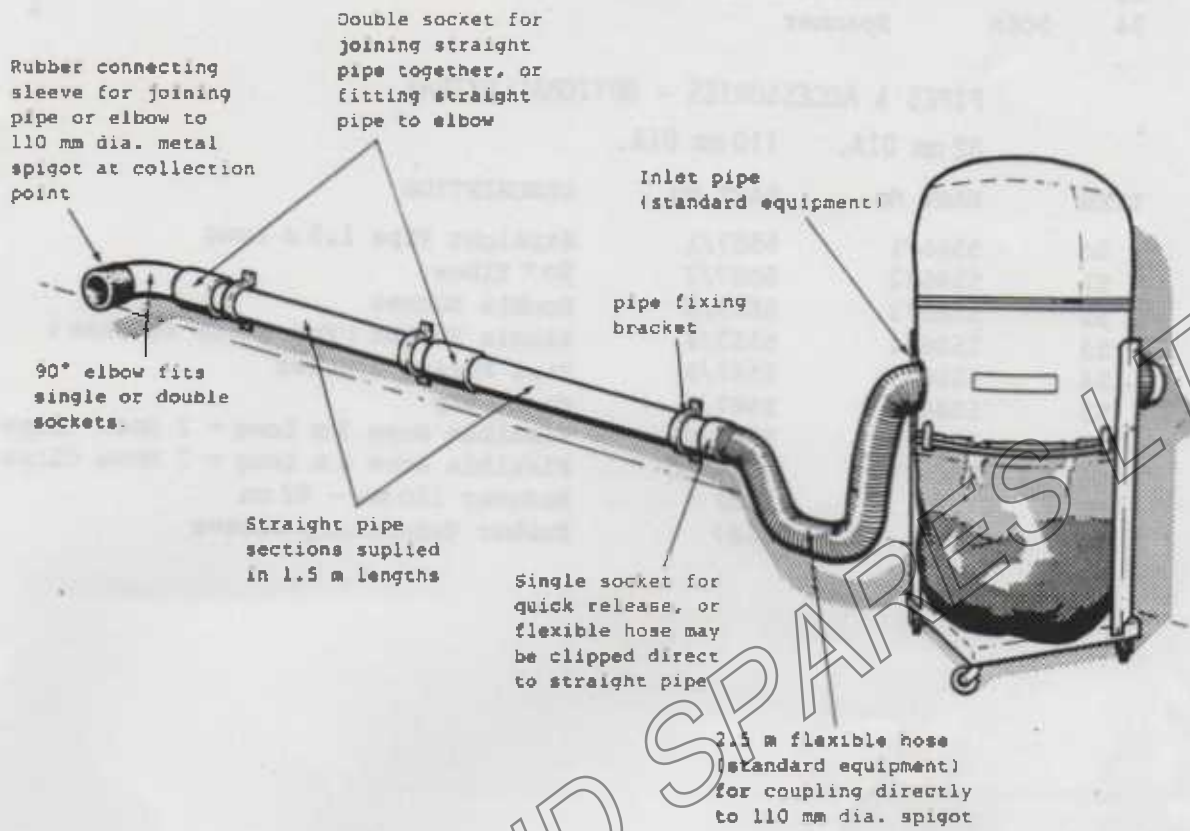

TYPICAL INSTALLATION SHOWING THE EXTRACTOR UNIT POSITIONED AWAY FROM THE COLLECTION POINT, USING OPTIONAL EXTRAS SHOWN BELOW.

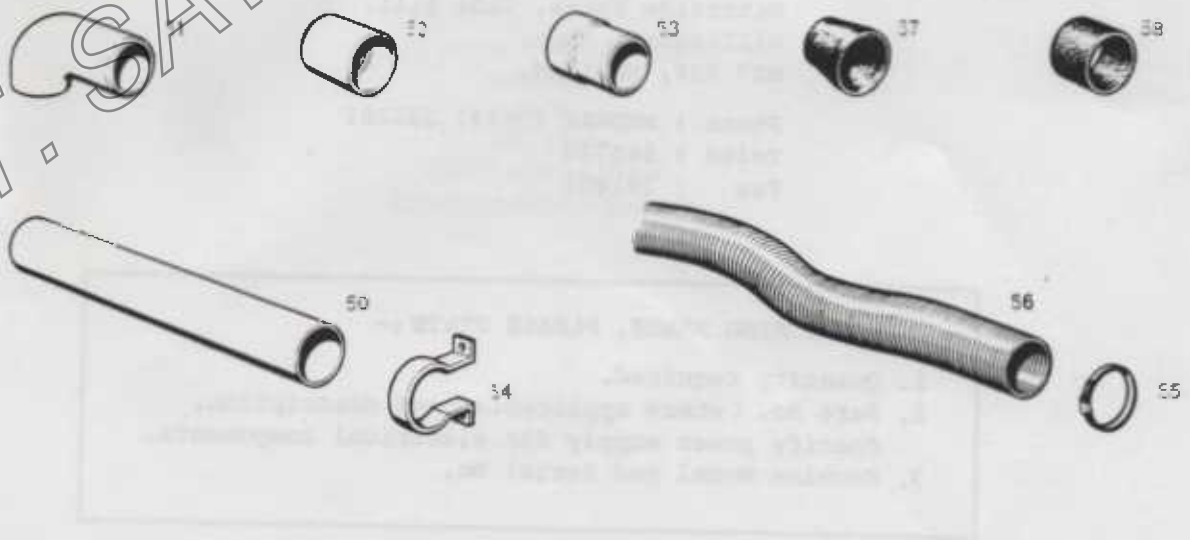

PIPES & ACCESSORIES - OPTIONAL EXTRAS

ASSEMBLY TOOL KIT (IN PLASTIC BAG) :

21	Hex. Hd. Screw M8 x 12 mm	13
22	Washer M8	26
23	Hex. Nut M8	13
34	5056 Spanner	1

PIPES & ACCESSORIES - OPTIONAL EXTRAS

82 mm DIA. 110 mm DIA.

ITEM	PART No.	PART No.	DESCRIPTION
50	5586/1	5587/1	Straight Pipe 1.5 m Long
51	5586/2	5587/2	90° Elbow
52	5586/3	5587/3	Double Socket
53	5586/4	5587/4	Single Socket (For quick release)
54	5586/5	5587/5	Pipe Fixing Bracket
55	5586/6	5587/6	Hose Clip
56	5586/9	5587/9	Flexible Hose 3 m Long + 2 Hose Clips
56	5586/10	5587/10	Flexible Hose 6 m Long + 2 Hose Clips
57	-	5809	Reducer 110 mm - 82 mm
58	-	5687	Rubber Connecting Sleeve

A.L.T. SAWS AND SPARES LTD

A.L.T. SAWS & SPARES LTD

(Startrite Machine Specialist)

Unit 25 Pier Road Industrial Estate

Gillingham

Kent

ME7 1RZ

Tel/Fax: 01634 850833

www.altsawsandspares.co.uk

WHEN ORDERING PARTS, PLEASE STATE :-

1. Quantity required.
2. Part No. (where applicable) and description.
Specify power supply for electrical components.
3. Machine Model and Serial No.

We reserve the right to change design and specification without notice.
Startrite Machine Tool Co. Ltd., Waterside Works, Gads Hill,
Gillingham, Kent, ME7 2SF, England.